

CNC ROUTER CUTTERS & CHUCKS

PRODUCTS	PAGE
Kinetic Dust Extractor	272
CNC Chucks	273~275
Precision Collets	276-277
Clamping Nuts	277
C-Spanner & Retaining Studs	278
HSK Chucks for Grooving Blade	278-279
Cutter Arbor	280
Universal Assembly Supports for Chucks	280
DLCS Coating Solid Carbide Spiral Bits	281-282, 285, 289
Solid Carbide Spiral Bits	282~290, 292
Spiral Bits for Locksets	291
HSS Upcut Spiral Bits	291
Solid Surface and Fiberglass Bits	293
CNC DP Straight Cutters	294~298
CNC Straight Carbide Cutters	298~301
CNC Cutters with Insert Knives	302~309
Slot & Mortise Bits	310~316



Kinetic Dust Extractor



992 Removes MDF & Chipboard dust from the workpiece

DESCRIPTION	D mm		ORDER NO.
Kinetic Dust Extractor for chucks with ER20	80	1	992.081.ER20
Kinetic Dust Extractor for chucks with ER25	80	1	992.081.ER25
Kinetic Dust Extractor for chucks with DIN6388/EOC25 collets	100	1	992.101.EOC25
Kinetic Dust Extractor for chucks with ER32 collets	100	1	992.101.ER32
Kinetic Dust Extractor for chucks with ER40 collets	100	1	992.101.ER40

Spare parts: **991.285.00** C-Spanner 80-90mm (ER20/ER25)
991.284.00 C-Spanner 95-100mm (EOC25/ER32/ER40)



EASY TO USE!

Installation and removal just like a clamping nut

- Better health & safety on the worksite
- Better air quality on the worksite
- Improves tool performance & cut quality
- Longer tool life & reduced labor costs
- Recommended for Nesting and routing operations
- No wasted time throughout operation
- Replaces the standard clamping nut
- Suitable for any collet chucks with standard router bits
- Available for ER32 - ER40 - EOC25 (DIN6388) collets
- Tough ceramic coating offers anti-corrosion, anti-friction and anti-static protection.
- Tool body in light alloy
- Lightweight and quiet
- Performs even at low RPM: from 6,000 up to 20,000 rpm
- Materials: chipboard, coated chipboard, MDF, CORIAN®, plasterboard, OSB, HPL.

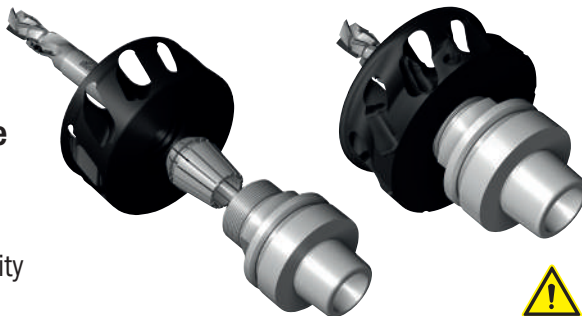

SAFETY TIPS:

The **TW-200** Torque Wrench is recommended for the proper fastening of clamping nuts (see page 406)

Always use vacuum system.

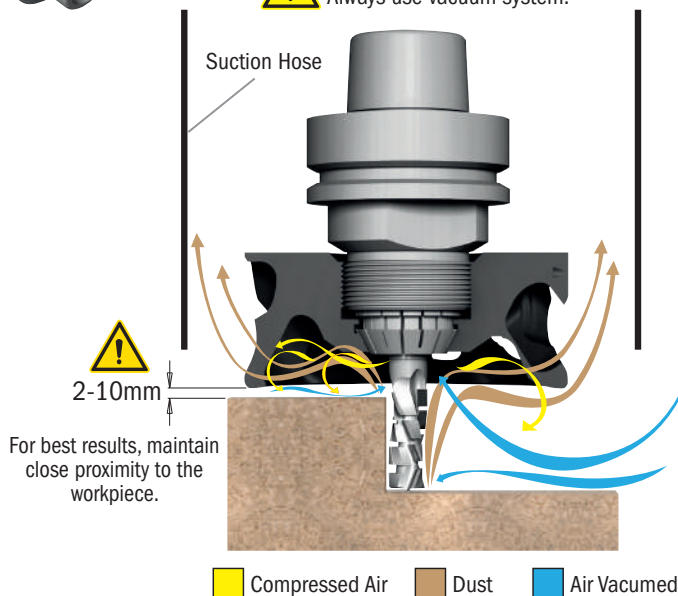

Download Instruction



Watch the video on **YouTube**

Working **WITHOUT** Kinetic Dust Extractor

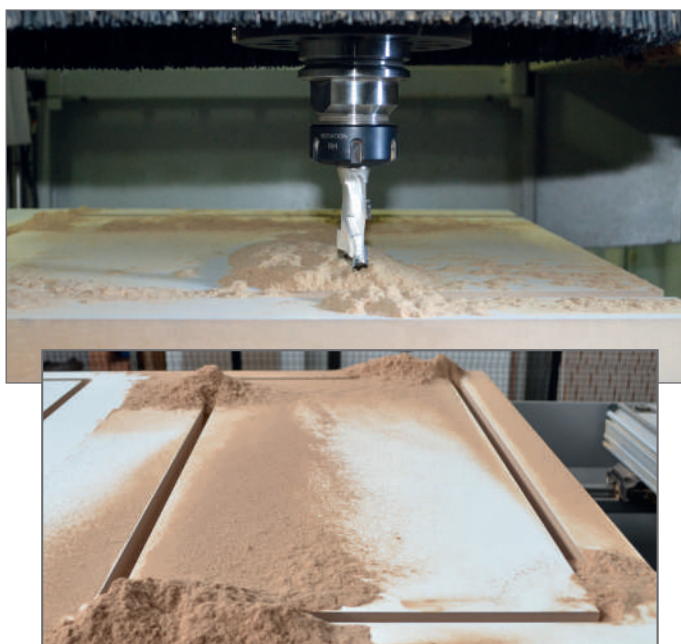

Working **WITH** Kinetic Dust Extractor



HSK-63F Chuck for "ER32" Precision Collets

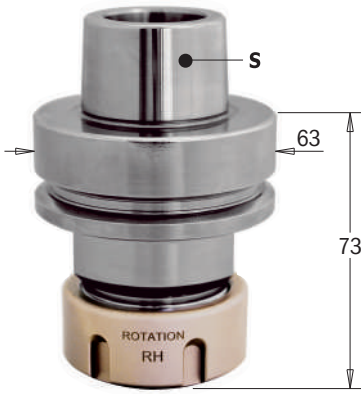

183.300 XTREME



S	TO BE USED WITH COLLET	ORANGE CHROME	NOTE	BOX	ORDER NO. Right-hand rotation	ORDER NO. Left-hand rotation
HSK-63F	ER32	✓	Clamping nut without bearing	1	183.300.01	183.300.02
HSK-63F	ER32	✓	Clamping nut with bearing	1	183.300.11*	
HSK-63F	ER32		Clamping nut without bearing	1	183.300.91	
HSK-63F	ER32		Clamping nut with bearing	1	183.300.93*	

Optional: 990.118.00 M6x10mm screw

* Suitable for right-hand and left-hand rotation.

For HOMAG®, EIMA®, IMA® FROM 9/94, WEEKE®, BIESSE®, SCM®, MORBIDELLI® and MASTERWOOD® machines.



Non-STICK ORANGE CHROME® SHIELD COATING

- prevents overheating
- protects against corrosion and rust
- reduces resin build-up
- longer life and greater tool performance

SAFETY TIPS:



The **TW-200** Torque Wrench is recommended for the proper fastening of clamping nuts (see page 406)

HSK-63F Chucks for "ER40" Precision Collets

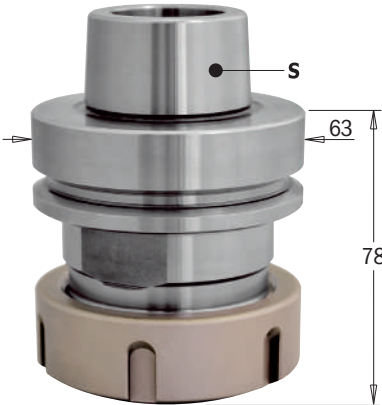

183.310 XTREME



S	TO BE USED WITH COLLET	ORANGE CHROME	NOTE	BOX	ORDER NO. Right-hand rotation	ORDER NO. Left-hand rotation
HSK-63F	ER40	✓	Clamping nut without bearing	1	183.310.01	183.310.02
HSK-63F	ER40	✓	Clamping nut with bearing	1	183.310.11*	
HSK-63F	ER40		Clamping nut without bearing	1	183.310.91	
HSK-63F	ER40		Clamping nut with bearing	1	183.310.93*	

Optional: 990.117.00 M6x6mm screw

* Suitable for right-hand and left-hand rotation.

For HOMAG®, EIMA®, IMA® FROM 9/94, WEEKE®, BIESSE®, SCM®, MORBIDELLI® and MASTERWOOD® machines.



Non-STICK ORANGE CHROME® SHIELD COATING

- prevents overheating
- protects against corrosion and rust
- reduces resin build-up
- longer life and greater tool performance

SAFETY TIPS:



The **TW-200** Torque Wrench is recommended for the proper fastening of clamping nuts (see page 406)

HSK-63F Chucks for "EOC25" Precision Collet "DIN6388"

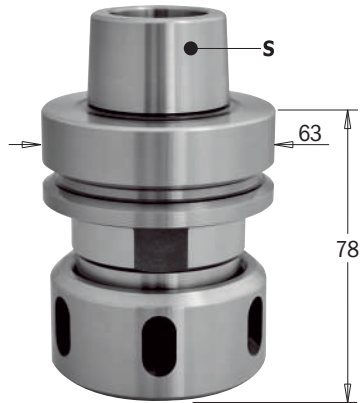

183.320



S	TO BE USED WITH COLLET	NOTE	BOX	ORDER NO. Right-hand rotation	ORDER NO. Left-hand rotation
HSK-63F	EOC25	Clamping nut with bearing	1	183.320.01*	
HSK-63F	EOC25	Clamping nut without bearing	1	183.320.03	

Spare parts: 992.283.01 Clamping nut without bearing
992.283.11 Clamping nut with bearing

* Suitable for left-hand rotation too.

For HOMAG®, EIMA®, IMA® FROM 9/94, WEEKE®, BIESSE®, SCM®, MORBIDELLI® and MASTERWOOD® machines.



Non-STICK ORANGE CHROME® SHIELD COATING

- prevents overheating
- protects against corrosion and rust
- reduces resin build-up
- longer life and greater tool performance

SAFETY TIPS:



The **TW-200** Torque Wrench is recommended for the proper fastening of clamping nuts (see page 406)

HSK-63F Chucks for Shrink Fit Holders

new

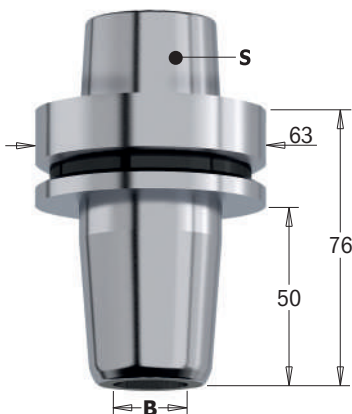

183.075



S	B mm	BOX	ORDER NO.
HSK-63F	12	1	183.075.12
HSK-63F	16	1	183.075.16
HSK-63F	20	1	183.075.20
HSK-63F	25	1	183.075.25

SPECIAL STEEL UNI 1.2344

- prevents overheating
- protects against corrosion and rust
- longer life and greater tool performance

ISO30 Chucks for "ER32" Precision Collets

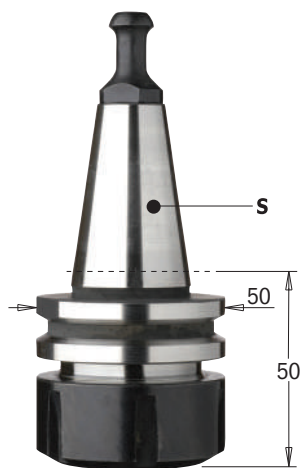

995.200

183.200

S	TO BE USED WITH COLLET	RETAINING STUD mm		ORDER NO. Right-hand rotation	ORDER NO. Left-hand rotation
ISO30	ER32	Ø12-8	 1	183.200.01	183.200.02

For BIESSE® machines.

RH LH



995.201

183.210

S	TO BE USED WITH COLLET	RETAINING STUD mm		ORDER NO. Right-hand rotation	ORDER NO. Left-hand rotation
ISO30	ER32	Ø13-9	 1	183.210.01	183.210.02

For BIESSE® machines with OMLAT® engine, NUOVA BULLERI BREVETTI®, BUSELLATO®, CMS® and IMA® machines.

RH LH



995.202

183.220

S	TO BE USED WITH COLLET	RETAINING STUD mm		ORDER NO. Right-hand rotation	ORDER NO. Left-hand rotation
ISO30	ER32	Ø12,8-9	 1	183.220.01	183.220.02

For ALBERTI® and MASTERWOOD® machines.

RH LH

SAFETY TIPS:



The **TW-200** Torque Wrench is recommended for the proper fastening of clamping nuts (see page 406)

ISO30 Chucks for "ER40" Precision Collets

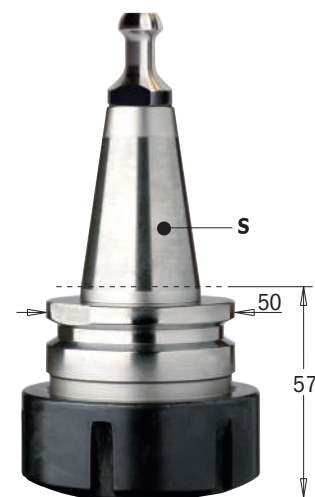

995.200

183.201

S	TO BE USED WITH COLLET	RETAINING STUD mm		ORDER NO. Right-hand rotation	
ISO30	ER40	Ø12-8	 1	183.201.01	

For BIESSE® machines.

RH



995.201

183.211

S	TO BE USED WITH COLLET	RETAINING STUD mm		ORDER NO. Right-hand rotation	
ISO30	ER40	Ø13-9	 1	183.211.01	

For BIESSE® machines with OMLAT® engine, NUOVA BULLERI BREVETTI®, BUSELLATO®, CMS® and IMA® machines.

RH



995.202

183.221

S	TO BE USED WITH COLLET	RETAINING STUD mm		ORDER NO. Right-hand rotation	
ISO30	ER40	Ø12,8-9	 1	183.221.01	

For ALBERTI® and MASTERWOOD® machines.

RH

SAFETY TIPS:



The **TW-200** Torque Wrench is recommended for the proper fastening of clamping nuts (see page 406)

ISO30 Chucks for "ER32" Precision Collets

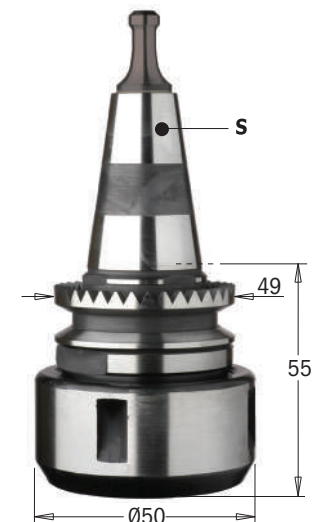

995.250

183.250

S	TO BE USED WITH COLLET	RETAINING STUD mm		ORDER NO. Right-hand rotation	ORDER NO. Left-hand rotation
ISO30	ER32	Ø8,5	 1	183.250.01	183.250.02

For MORBIDELLI® and SCM® machines.

RH LH

SAFETY TIPS:



The **TW-200** Torque Wrench is recommended for the proper fastening of clamping nuts (see page 406)

Chucks for "ER32" Precision Collets

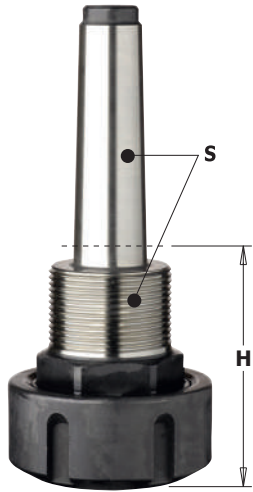

183.000/100

RH LH

S mm	TO BE USED WITH COLLET	H mm		ORDER NO. Right-hand rotation	ORDER NO. Left-hand rotation
MK2/M30x1,5	ER32	62	1	183.000.01	183.000.02
MK3/M30x1,5	ER32	70	1	183.100.01	

MK2/MK3 tapered shank

SAFETY TIPS:

The **TW-200** Torque Wrench is recommended for the proper fastening of clamping nuts (see page 406)

Chucks for "ER32" Precision Collets

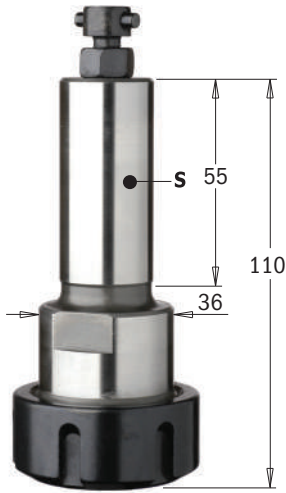

183.400

RH

S mm	TO BE USED WITH COLLET	RETAINING STUD		ORDER NO. Right-hand rotation	
Ø25x55	ER32	LEUCO® P-SYSTEM®	1	183.400.01	

For machines with LEUCO® P-SYSTEM®.

SAFETY TIPS:

The **TW-200** Torque Wrench is recommended for the proper fastening of clamping nuts (see page 406)

Collet Chucks Clamp with MK2 Tapered Shank

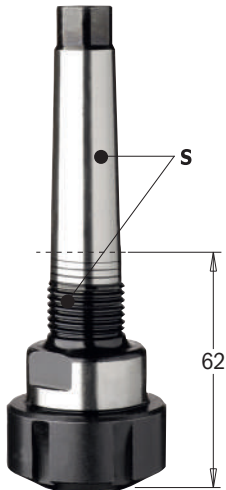

123

RH LH

S		ORDER NO. Right-hand rotation	ORDER NO. Left-hand rotation
MK2/Ø20x14Fx1"	1	123.000.01	123.000.02

Spare parts: **992.123.01** Clamping nut RH
992.123.02 Clamping nut LH
991.123.00 C-spanner

SAFETY TIPS:

The **TW-200** Torque Wrench is recommended for the proper fastening of clamping nuts. The **TW-2836** Hook Insert can be used with this item (see page 406).

Collets for 123 Chucks



124

B mm		ORDER NO.	B mm		ORDER NO.
6	1	124.060.00	10	1	124.100.00
6,35	1	124.064.00	12,7	1	124.120.00
8	1	124.080.00	12,7	1	124.127.00
9,5	1	124.095.00	14	1	124.140.00

Precision Collets "DIN6499"

184

TECHNICAL DETAILS:

Replaceable **Standard Precision 0.015** collets. 0; -0,7mm wide clamping tolerance.
 Replaceable **High Precision 0.005** collets. 0; -1mm wide clamping tolerance.
 Suitable for most conical chucks. Fit most tapered spindle noses.

☐ Special dimensions available on request.

STANDARD



HIGH



RUN-OUT
 This tolerance is guaranteed only on the nominal diameter

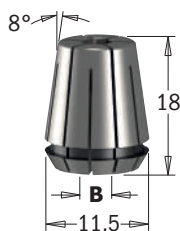

ER11

B mm	ORDER NO. STANDARD
2	184.020.11
3	184.030.11
4	184.040.11
5	184.050.11
6	184.060.11

10 pcs. Masterpack



ER16

B mm	B inches	ORDER NO. STANDARD	B mm	B inches	ORDER NO. STANDARD
2		184.020.16	7		184.070.16
3		184.030.16	8	5/16	184.080.16
4		184.040.16	9		184.090.16
5		184.050.16	10		184.100.16
6		184.060.16			

10 pcs. Masterpack



ER20

B mm	B inches	ORDER NO. STANDARD	B mm	B inches	ORDER NO. STANDARD
2	5/16	184.020.20	8	5/16	184.080.20
3		184.030.20	9		184.090.20
4		184.040.20	10		184.100.20
5		184.050.20	11		184.110.20
6		184.060.20	12		184.120.20
6,35	1/4	184.064.20	12,7	1/2	184.127.20
7		184.070.20			

10 pcs. Masterpack



ER25

B mm	B inches	ORDER NO. STANDARD
3		184.030.25
4		184.040.25
5		184.050.25
6		184.060.25
6,35	1/4	184.064.25
8	5/16	184.080.25
9		184.090.25
10		184.100.25
12		184.120.25
12,7	1/2	184.127.25
14		184.140.25
16	5/8	184.160.25

10 pcs. Masterpack



For chucks:

183.000/100/200/250/300/400

ER32



B mm	B inches	ORDER NO. STANDARD	ORDER NO. HIGH new	B mm	B inches	ORDER NO. STANDARD	ORDER NO. HIGH new
3		184.030.00		11		184.110.00	
4		184.040.00	184.040.00H	12		184.120.00	184.120.00H
5		184.050.00		12,7	1/2	184.127.00	
6		184.060.00	184.060.00H	14		184.140.00	
6,35	1/4	184.065.00		15		184.150.00	
7		184.070.00		16	5/8	184.160.00	184.160.00H
8	5/16	184.080.00	184.080.00H	17		184.170.00	
9		184.090.00		18		184.180.00	
9,52	3/8	184.095.00		19	3/4	184.190.00	
10		184.100.00		20		184.200.00	184.200.00H

10 pcs. Masterpack



For chucks:

183.201/211/221/310

ER40



B mm	B inches	ORDER NO. STANDARD	ORDER NO. HIGH new	B mm	B inches	ORDER NO. STANDARD	ORDER NO. HIGH new
3		184.032.00		12		184.122.00	184.122.00H
4		184.042.00		12,7	1/2	184.128.00	
5		184.052.00		14		184.142.00	
6		184.062.00	184.062.00H	16	5/8	184.162.00	184.162.00H
6,35	1/4	184.064.00		18		184.182.00	
7		184.072.00		19	3/4	184.192.00	
8	5/16	184.082.00	184.082.00H	20		184.202.00	184.202.00H
9,52	3/8	184.096.00		25		184.252.00	184.252.00H
10		184.102.00					

10 pcs. Masterpack

Precision Collets "DIN6388"

185

TECHNICAL DETAILS:

Replaceable **Standard Precision 0.015** collets. 0; -0,7mm wide clamping tolerance.
Suitable for most conical chucks. Fit most tapered spindle noses.

Special dimensions available on request.



EOC25

mm	B inches		ORDER NO.	mm	B inches		ORDER NO.
3		10	185.030.00	12		10	185.120.00
4		10	185.040.00	12,7	1/2	10	185.127.00
5		10	185.050.00	14		10	185.140.00
6		10	185.060.00	16	5/8	10	185.160.00
6,35	1/4	10	185.064.00	18		10	185.180.00
8	5/16	10	185.080.00	19	3/4	10	185.191.00
9,5	3/8	10	185.095.00	20		10	185.200.00
10		10	185.100.00	25		10	185.250.00

EOC16

mm	B inches		ORDER NO.	mm	B inches		ORDER NO.
6		10	185.060.16	12		10	185.120.16
8	5/16	10	185.080.16	14		10	185.140.16
10		10	185.100.16	16	5/8	10	185.160.16

Clamping Nuts



new

992.583 for «ER25»

RH LH

DESCRIPTION	D mm	S mm		ORDER NO. Right-hand rotation	ORDER NO. Left-hand rotation
Clamping nut without bearing					
Clamping nut with bearing ER25	42	M32x1,5	1	992.583.01	992.583.02

992.183 for «ER32»

RH LH

DESCRIPTION	D mm	S mm		ORDER NO. Right-hand rotation	ORDER NO. Left-hand rotation
Clamping nut without bearing					
For 183.000/100/200/250/300/400 chucks	50	M40x1,5	1	992.183.01	992.183.02
Clamping nut with bearing					
For 183.000/100/200/250/300/400 chucks	50	M40x1,5	1	992.183.11	992.183.12

992.383 for «ER40»

RH LH

DESCRIPTION	D mm	S mm		ORDER NO. Right-hand rotation	ORDER NO. Left-hand rotation
Clamping nut without bearing					
For 183.201/211/221/310 chucks	63	M50x1,5	1	992.383.01	992.383.02
Clamping nut with bearing					
For 183.201/211/221/310 chucks	63	M50x1,5	1	992.383.11	

992.283 for «EOC25»

RH

DESCRIPTION	D mm	S mm		ORDER NO. Right-hand rotation	
Clamping nut without bearing for chuck 183.320	60	M48x2	1	992.283.01	
Clamping nut with bearing for chuck 183.320	60	M48x2	1	992.283.11	

C-Spanner

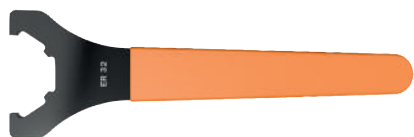

991.183 for «ER32»

DESCRIPTION		ORDER NO.
C-Spanner for «ER32»	1	991.183.00

991.184 for «ER40»

DESCRIPTION		ORDER NO.
C-Spanner for «ER40»	1	991.184.00



991.283 for «DIN6388» and «ER40»

DESCRIPTION		ORDER NO.
C-Spanner for 58-62-65	1	991.283.00

Cap Nuts for CNC Machines



993.0

RH LH

INTERNAL THREAD		ORDER NO. Right-hand rotation	ORDER NO. Left-hand rotation
Ø20x14F.1"	1	993.020.01	993.020.02
M30x1,5	1		993.030.02

For machines with M33x3 threaded spindle nose.

ISO30 Retaining Studs



DESCRIPTION	D mm	D ₂ mm	ORDER NO.
For 183.200/201 BIESSE® chucks	8	12,8	995.200.00
For 183.210/211 BIESSE®, OMLAT®, NUOVA BULLERI BREVETTI®, BUSELLATO®, WEEKE®, IMA® chucks	9	13	995.201.00
For 183.220/221 ALBERTI® - MASTERWOOD® chucks	9	12,8	995.202.00
For 183.250/251 SCM® - MORBIDELLI® chucks	6,5	8,5	995.250.00
For LEUCO® P-SYSTEM® 183.400 chucks	M8		995.400.00

Saw Blade Arbor with Parallel Shank

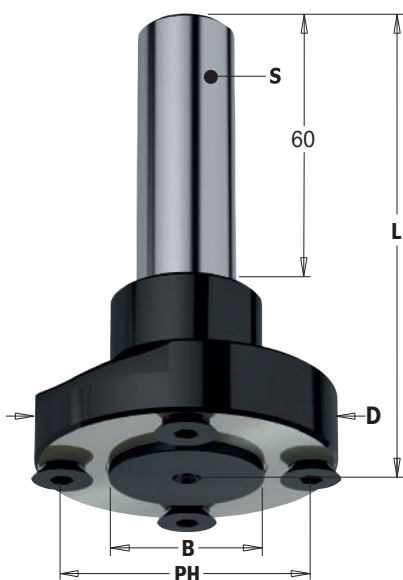

183.410

LH RH

S mm	D mm	B mm	PIN HOLE	L mm		ORDER NO.
20	59	30	4/M6/48	97,5	1	183.410.30

Spare parts: 990.116.00 M6x8,7x12mm TSPEI screw (to use with Plate Thickness ≥ 2,2mm)
 991.067.00 3mm allen key
 991.064.00 4mm allen key

Max saw blade Ø250mm

Optional: 990.083.00 M6x8x10mm TSPEI screw (to use with Plate Thickness < 2,2mm)

SAFETY TIPS:

The **TW-006** Torque Screwdriver is recommended for the proper fastening of screws (see page 406).

Grooving saw blades available at page 60 on request.

HSK Chuck for Grooving Blade

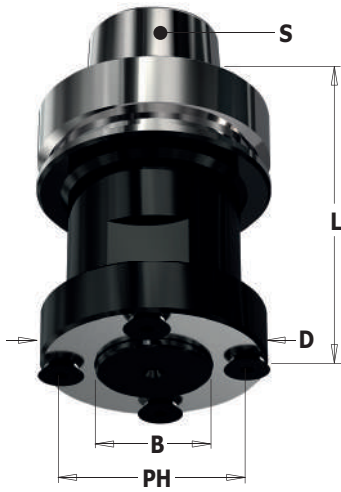

183.420

LH RH

S	D mm	B mm	PIN HOLE	L mm		ORDER NO.
HSK-63F	59	30	4/M6/48	78	1	183.420.30

Spare parts: 990.116.00 M6x8,7x12mm TSPEI screw
991.064.00 4mm allen key



Max saw blade \varnothing 250mm for chuck 183.420.30

Do not exceed maximum RPM indicated on the blade.

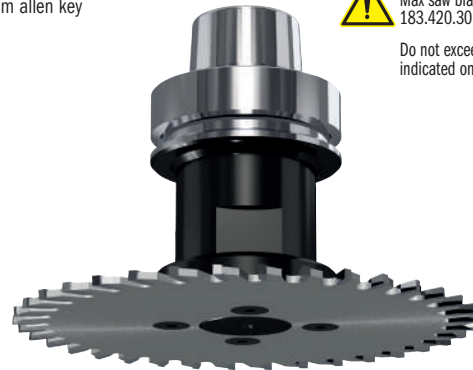

Grooving saw blades available at page 60 on request.

SAFETY TIPS:



The **TW-006** Torque Screwdriver is recommended for the proper fastening of screws (see page 406).

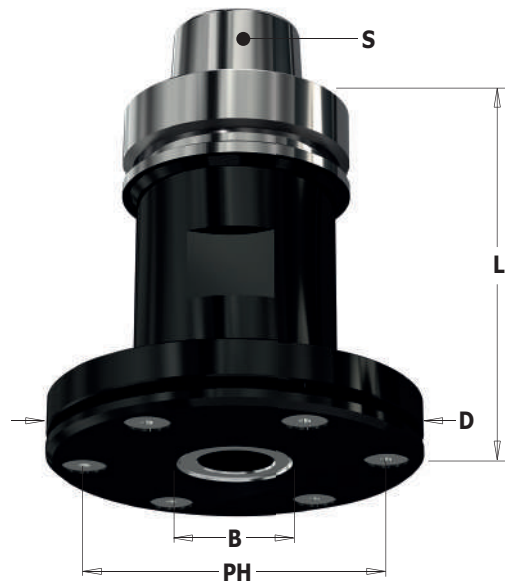

183.421

LH RH

S	D mm	B mm	PIN HOLE	L mm		ORDER NO.
HSK-63F	98	30	6/M6/80	94	1	183.421.30

Spare parts: 990.119.00 M6x12x16mm TSPEI screw
991.064.00 4mm allen key



Max saw blade \varnothing 300mm for chuck 183.421.30

Do not exceed maximum RPM indicated on the blade.

with flange \varnothing 98mm



Grooving saw blades available on request.

SAFETY TIPS:



The **TW-006** Torque Screwdriver is recommended for the proper fastening of screws (see page 406).

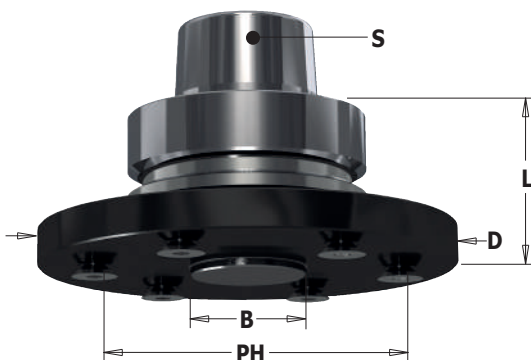

183.422

LH RH

S	D mm	B mm	PIN HOLE	L mm		ORDER NO.
HSK-63F	110	30	6/M6/80	40	1	183.422.30

Spare parts: 990.116.00 M6x8,7x12mm TSPEI screw
991.064.00 4mm allen key



Max saw blade \varnothing 350mm for chuck 183.422.30

Do not exceed maximum RPM indicated on the blade.



Grooving saw blades available on request.

SAFETY TIPS:



The **TW-006** Torque Screwdriver is recommended for the proper fastening of screws (see page 406).

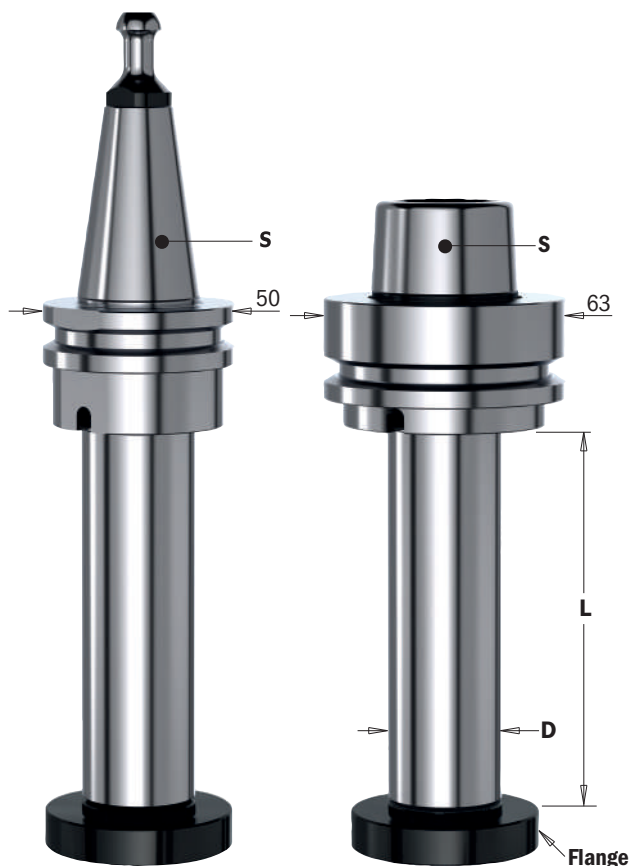

183.260

LH RH

S	DESCRIPTION	D x L mm		ORDER NO.
ISO30	Cutter arbor with ISO30 tapered shank	30x100	1	183.260.00

For BIESSE® machines.

REMARK: special dimensions available on request.

183.360

LH RH

S	DESCRIPTION	D x L mm		ORDER NO.
HSK-63F	Cutter arbor with HSK tapered shank	30x100	1	183.360.00
HSK-63F	Cutter arbor with HSK tapered shank	30x150	1	183.360.10
HSK-63F	Cutter arbor with HSK tapered shank	35x100	1	183.361.00
HSK-63F	Cutter arbor with HSK tapered shank	40x100	1	183.362.00

For HOMAG®, EIMA®, IMA® FROM 9/94, WEEKE®, BIESSE®, SCM®, MORBIDELLI® and MASTERWOOD® machines.

SAFETY TIPS: The **TW-006** Torque Screwdriver is recommended for the proper fastening of screws (see page 406).

Spare Parts for Chucks



DESCRIPTION	ORDER NO.	DESCRIPTION	ORDER NO.
M6x25 TCEI screw	990.098.00	Optional Steel Flange	
Steel flange for with Ø30mm arbors - Male	992.560.30M	For with Ø30mm arbors - Female	992.560.30F
Steel flange for with Ø35mm arbors - Male	992.560.35M	For with Ø35mm arbors - Female	992.560.35F
Steel flange for with Ø40mm arbors - Male	992.560.40M	For with Ø40mm arbors - Female	992.560.40F

Universal Assembly Supports for Chucks



183

SUITABLE FOR	D mm		ORDER NO.
HSK-63, BT40, ISO40 DIN 2080, SK40 DIN 69871, CAPTO® C6	63	1	183-HSK
ISO30, DIN 2080, SK30 DIN 69871, HSK50, CAPTO® C5	50	1	183-ISO*

*Not compatible with chucks **183.250** and **183.251**

CMT now offers new universal assembly supports for HSK-63F and ISO30 chucks. Thanks to the bi-directional roller bearings, which clamp the Left-hand rotation to the flange, the system offers the highest protection to the tool taper and clamps are no longer needed.

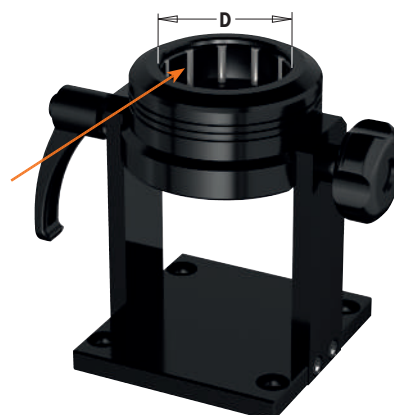

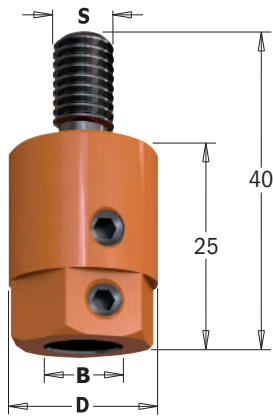

301

RH LH

B mm	D mm	S mm		ORDER NO. Right-hand rotation	ORDER NO. Left-hand rotation
8	16	M8	10	301.080.01	301.080.02
10	19,5	M8	10	301.000.01	301.000.02

FOR USE ON THE FOLLOWING MACHINES:
NOTTMEYER® (older models).

Spare parts

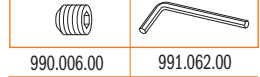

990.006.00

991.062.00

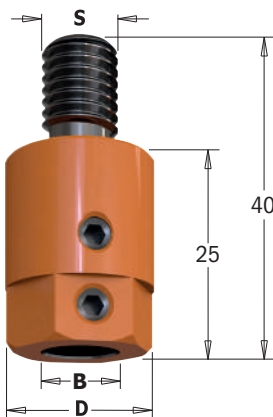

302

RH LH

B mm	D mm	S mm		ORDER NO. Right-hand rotation	ORDER NO. Left-hand rotation
8	16	M10	10	302.080.01	302.080.02
10	19,5	M10	10	302.000.01	302.000.02

FOR USE ON THE FOLLOWING MACHINES:
AYEN®, HOLZMA®, KNOEVENAGEL®, MAYER®, TORWEGGE®.

Spare parts



990.006.00

991.062.00

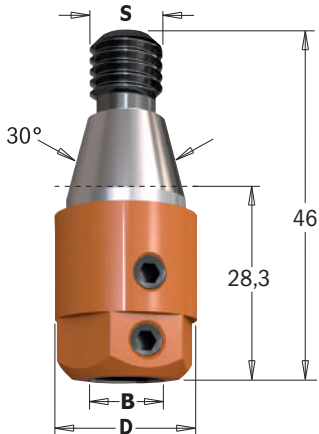

303

RH LH

B mm	D mm	S mm		ORDER NO. Right-hand rotation	ORDER NO. Left-hand rotation
8	16	M10/30°	10	303.080.01	303.080.02
10	19,5	M10/30°	10	303.000.01	303.000.02

FOR USE ON THE FOLLOWING MACHINES:
ALBERTI® (older models).
BALESTRINI®, BILEK®, BUSELLATO® (older models).
SCHLEICHER®, VITAP® (older models).

Spare parts



990.006.00

991.062.00



304

RH LH

B mm	D mm	S mm		ORDER NO. Right-hand rotation	ORDER NO. Left-hand rotation
8	16	M8/20° 48'	10	304.080.01	304.080.02
10	19,5	M8/20° 48'	10	304.000.01	304.000.02

FOR USE ON THE FOLLOWING MACHINES:
BALESTRINI®, BILEK®.

Spare parts



990.006.00

991.062.00

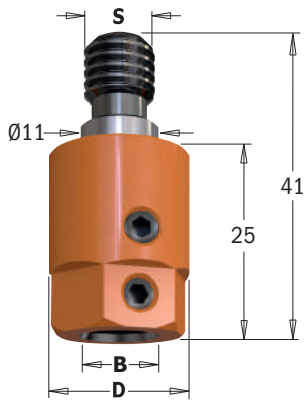

305

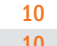

RH LH

B mm	D mm	S mm		ORDER NO. Right-hand rotation	ORDER NO. Left-hand rotation
8	16	M10/11		305.080.01	305.080.02
10	19,5	M10/11		305.000.01	305.000.02

FOR USE ON THE FOLLOWING MACHINES:

BIESSE® (older models).
 MASTERWOOD® (Zangheri & Boschetti).
 MORBIDELLI®, TORWEGGE®, VITAP® (new design).
 WEEKE®.

Spare parts

	
990.006.00	991.062.00

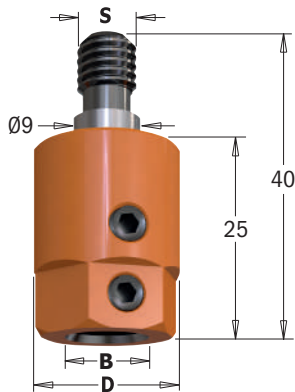

358

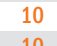

RH LH

B mm	D mm	S mm		ORDER NO. Right-hand rotation	ORDER NO. Left-hand rotation
8	16	M8/9		358.080.01	358.080.02
10	19,5	M8/9		358.000.01	358.000.02

FOR USE ON THE FOLLOWING MACHINES:

MASTERWOOD® (Zangheri & Boschetti).
 MORBIDELLI®, NOTTMEYER® (new design).

Spare parts

	
990.006.00	991.062.00



359



RH LH

B mm	D mm	S mm		ORDER NO. Right-hand rotation	ORDER NO. Left-hand rotation
10	19,5	M10		359.000.01	359.000.02

FOR USE ON THE FOLLOWING MACHINES:

SCHEER®.

Spare parts

	
990.006.00	991.062.00



360.001

RH LH

B mm	d mm	D mm		ORDER NO. Right-hand rotation	ORDER NO. Left-hand rotation
10	20	15		360.001.01	360.001.02

FOR USE ON THE FOLLOWING MACHINES:

BIESSE® machines with quick drill change chuck.

Spare parts

	
990.007.00	991.067.00



360.101



B mm	d mm	D mm		ORDER NO.
10	17,5	18	10	Right-hand & Left-hand rotation 360.101.00

FOR USE ON THE FOLLOWING MACHINES:
VITAP®.

Spare parts	
990.015.00	991.062.00



360.201



B mm	d mm	D mm		ORDER NO.
10	19,5	20	10	Right-hand & Left-hand rotation 360.201.00

FOR USE ON THE FOLLOWING MACHINES:
MORBIDELLI®.

Spare parts	
990.009.00	991.067.00



360.301



B mm	d mm	D mm		ORDER NO.
10	19,5	20	10	Right-hand & Left-hand rotation 360.301.00

FOR USE ON THE FOLLOWING MACHINES:
MASTERWOOD®, MAGGI®, GRIGGIO®.

Spare parts	
990.015.00	991.062.00



360.401



B mm	d mm	D mm		ORDER NO.
10	20	17	10	Right-hand & Left-hand rotation 360.401.00

FOR USE ON THE FOLLOWING MACHINES:
WEEKE®.

Spare parts	
990.009.00	991.067.00



990.088



DESCRIPTION		ORDER NO.
Retaining screw for WEEKE® machines	10	Right-hand & Left-hand rotation 990.088.00

Arbors

797

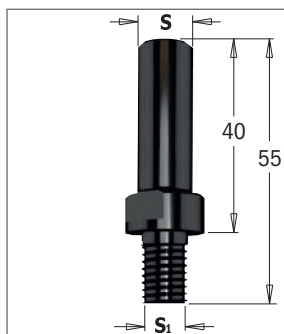

S mm	S ₁ mm			ORDER NO.
8	M10x1,5		10	797.580.00
10	M12x1		10	797.100.00
12	M12x1		10	797.120.00
12,7	M12x1		10	797.127.00

TECHNICAL DETAILS:

- Super strength steel.
- Precisely machined for accuracy.

Collet Chucks

796

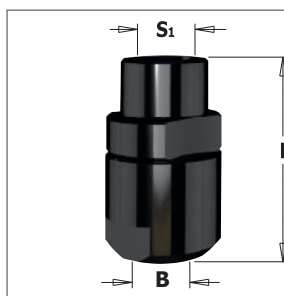

S ₁ mm	B mm	L mm			ORDER NO.
M10x1,5	6 - 6,35 - 8 - 9,5	38		10	796.100.00
M12x1	6 - 6,35 - 8 - 9,5	38		10	796.000.00
M12x1	10 - 12 - 12,7	47		10	796.121.00

TECHNICAL DETAILS:

- Super strength steel.
- Precisely machined for accuracy.

Collet not included.

Router Chuck Extensions with Collet

796.001/002

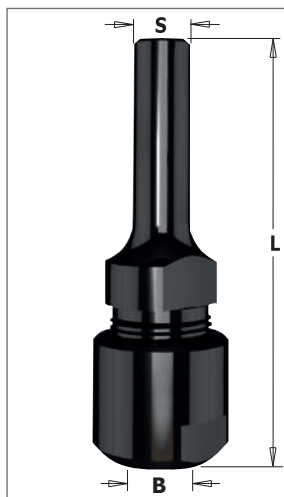

S mm	COLLET INCLUDED mm	FOR COLLETS mm	L mm			ORDER NO.
12	8	6 - 6,35 - 8 - 9,5	81		10	796.002.01
12	12	10 - 12 - 12,7	88		10	796.002.00
12,7	6,35	6 - 6,35 - 8 - 9,5	81		10	796.001.01
12,7	12,7	10 - 12 - 12,7	88		10	796.001.00

TECHNICAL DETAILS:

- Super strength steel.
- Precisely machined for accuracy.

Collet included.

Collet Chucks

796

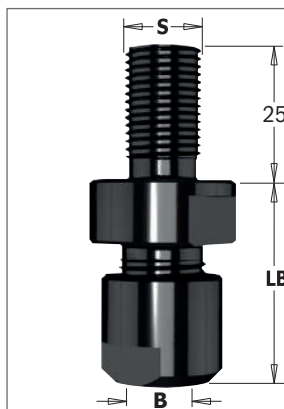

S mm	FOR COLLETS mm	LB mm			ORDER NO.
M14x2	6 - 6,35 - 8 - 9,5	32		10	796.140.00
M14x2	10 - 12 - 12,7	38		10	796.141.00
M16x2	6 - 6,35 - 8 - 9,5	32		10	796.160.00
M16x2	10 - 12 - 12,7	38		10	796.161.00

TECHNICAL DETAILS:

- Super strength steel.
- Precisely machined for accuracy.

Collet not included.

Collets

796.500/600



B mm		ORDER NO.	B mm		ORDER NO.
6	10	796.560.00	10	10	796.600.00
6,35	10	796.564.00	12	10	796.620.00
8	10	796.580.00	12,7	10	796.627.00
9,5	10	796.595.00			

new

Router Chuck Extension

796.003

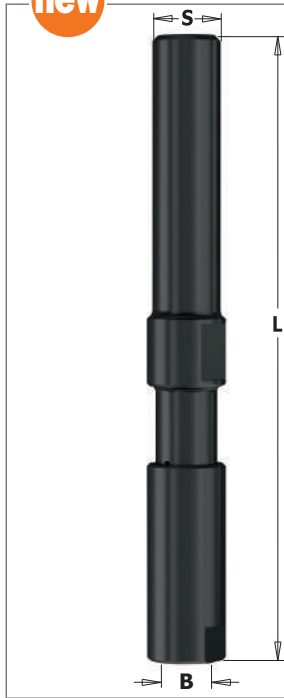

S mm	B mm	L mm		ORDER NO.
12	8	100	10	796.003.08

TECHNICAL DETAILS:

- High strength resistant steel.
- Precisely machined for accuracy.

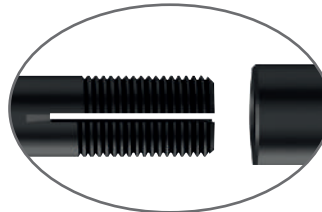

Collet not required

“ER20” Chucks

796

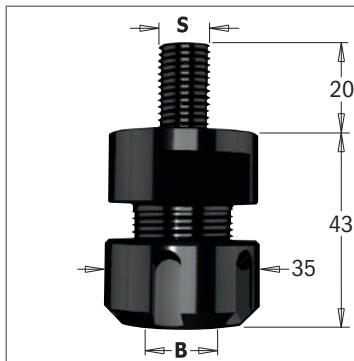

S mm	FOR COLLETS mm	LB mm		ORDER NO.
M12x1,75	3 ~ 12,7	43	10	796.122.00
M14x2	3 ~ 12,7	43	10	796.142.00
M16x2	3 ~ 12,7	43	10	796.162.00

Spare parts: 992.483.03 M25x1,5mm clamping nut
991.483.00 “ER20” key

TECHNICAL DETAILS:

- Super strength steel.
- Precisely machined for accuracy.

Collet not included.

SAFETY TIPS:



The **TW-200** Torque Wrench is recommended for the proper fastening of clamping nuts. (see page 406)

“ER20” Precision Collets for 796.122/142/162

184

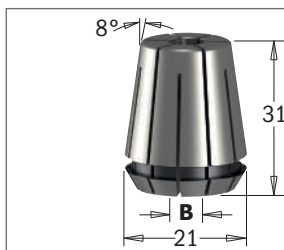

B mm		ORDER NO.	B mm		ORDER NO.
3	10	184.030.20	8	10	184.080.20
5	10	184.050.20	10	10	184.100.20
6	10	184.060.20	12	10	184.120.20
6,35	10	184.064.20	12,7	10	184.127.20

Collets for CMT1E, CMT2E, DEWALT®, FELISATTI®, FEIN®, METABO® Hand-Held Routers **796**

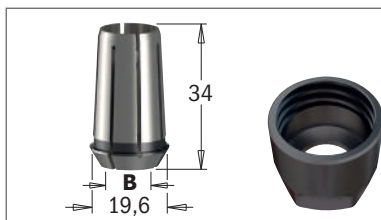

B mm		ORDER NO.	B mm		ORDER NO.
6	10	796.860.00	10	10	796.900.00
6,35	10	796.864.00	12	10	796.920.00
8	10	796.880.00	12,7	10	796.927.00
9,5	10	796.895.00			

Spare parts: 992.100.01 M22 Clamping nut

Collets for FREUD®/CASALS® Hand-Held Routers

796.780

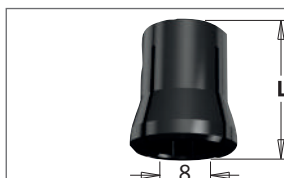

B mm	L mm		ORDER NO.
8	14	10	796.780.00

Bushings

799

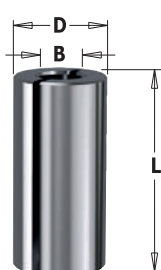

B mm	D mm	L mm			ORDER NO.
6	8	25		10	799.060.00
6	9,5	25		10	799.160.00
6	12	25		10	799.260.00
6,35	8	25		10	799.064.00
6,35	9,5	25		10	799.164.00
6,35	12,7	25		10	799.264.00
8	9,5	25		10	799.180.00
8	10	25		10	799.280.00
8	12	25		10	799.380.00
8	12,7	25		10	799.480.00
9,5	12,7	25		10	799.001.00
10	12	25		10	799.100.00
13	16	45		10	799.130.00

Arbors

798

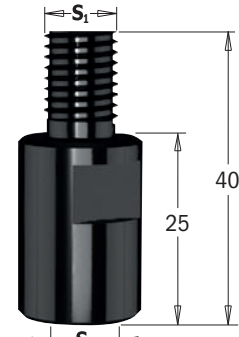



S mm	S ₁ mm			ORDER NO.
M10x1,5	M10x1,5		10	798.101.00
M10x1,5	M12x1		10	798.102.00
M12x1	M10x1,5		10	798.121.00
M12x1	M12x1		10	798.122.00

TECHNICAL DETAILS:
 - Super strength steel.
 - Precisely machined for accuracy.

Slot Cutter Arbors

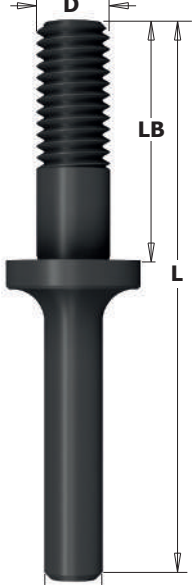
7/8/924



D mm	LB mm	L mm		ORDER NO. S=Ø6mm	ORDER NO. S=Ø6,35mm	ORDER NO. S=Ø8mm	ORDER NO. S=Ø12mm	ORDER NO. S=Ø12,7mm
Arbors for 822 Slot Cutters								
M8	23	71	10				924.133.00	824.133.00
M8	26	61	10	724.060.00	824.064.00	924.080.00		
M8	26	67,5	10				924.120.00	824.127.00
M8	29,75	71	10				924.131.00	824.131.00
M8	35,5	71	10				924.132.00	824.132.00
M8	40	81	10				924.128.00	824.128.00
M8	40	86	10			924.083.00		
M8	41	85	10				924.136.00	824.136.00
M8	47	97	10				924.130.00	824.130.00
M8	57	100	10				924.137.00	824.137.00
M12	39,5	85	10				924.134.00	824.134.00
M12	54	97	10				924.129.00	824.129.00
M12	54,5	100	10				924.135.00	824.135.00

Slot Cutter Arbors

7/8/924

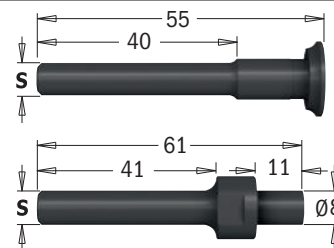

D mm	LB mm	L mm		ORDER NO. S=Ø6mm	ORDER NO. S=Ø6,35mm	ORDER NO. S=Ø8mm	ORDER NO. S=Ø12,7mm
Arbors for 823 Slot Cutters with Counterbore							
		55	10	724.061.00	824.061.00	924.081.00	824.121.00
8	11	61	10	724.062.00		924.082.00	824.122.00